

8kg Washing Machine - Instruction Manual Model: CK8588



To avoid risk of accidents or damage to the appliance, it is essential to read these instructions before it is installed and used for the first time.



Caterkwik Ltd

The Lakeland Catering Centre
Newlands
Ulverston
Cumbria
LA12 7QQ

01229 480001

info@caterkwik.co.uk

Contents

Safety Instructions

- Safety Instructions 2

Installation

- Product Description 9
- Installation 10

Operation

- Quick Start 13
- Before Each Cycle 15
- Detergent Dispenser 16
- Control Panel 18
- Programmes..... 19
- Options..... 27

Maintenance

- Cleaning and Care 31
- Trouble Shooting 34
- Technical Specifications 35
- Product Features 36

Safety Instructions

■ Safety Instructions

Please read the following safety information thoroughly and follow it strictly to minimize the risk of fire or explosion, electric shock and to prevent property damage, personal injury or loss of life. Failing to follow these instructions shall void any warranty.

Warning

This combination of symbol and signal word indicates a potentially dangerous situation which may result in death or serious injuries unless it's avoided.

Caution

This combination of symbol and signal word indicates a potentially dangerous situation which may result in slight or minor injuries or damage to property and the environment.

Note

This combination of symbol and signal word indicates a potentially dangerous situation which may result in slight or minor injuries.

Warning

Electric Shock Hazard

- If the supply cord is damaged, it must be replaced by the manufacturer, its service agent or similarly qualified persons in order to avoid a hazard.
- If the machine is damaged, it must not be operated unless repaired by the manufacturer, its service agent or similarly qualified persons.

Safety Instructions

- The appliance can be used by children aged from 8 years and above and persons with reduced physical, sensory or mental capabilities or lack of experience and knowledge if they have been given supervision or instruction concerning use of the appliance in a safe way and understand the hazards involved. Children shall not play with the appliance. Cleaning and user maintenance shall not be carried out by children without supervision.
- Children should be supervised that they do not play with the appliance.
- Children 3 years and under shall be kept away from the appliance or continuously supervised.
- Animals and children may climb into the machine. Check the machine before every operation.
- Do not climb or sit on the appliance.

Installation and Location

- All washing detergents and additional substances are to be kept in a safe place out of the reach of children.
- Do not install the machine on a carpet floor. The obstruction of the openings by a carpet may damage the machine.
- Keep the appliance clear from heat sources and direct sunlight to avoid plastic and rubber parts degrading.
- Do not use the appliance in humid environments or rooms containing explosive or caustic gas. In case of water leakage or water splashes let the appliance dry in the open air.
- The appliance must not be installed behind a lockable door, a sliding door or a door with a hinge on the opposite side to that of the washing machine.

Safety Instructions

- Do not operate the machine in rooms with a temperature of below 5°C. This may cause damage. If it is unavoidable, make sure to drain the water completely from the appliance after every use (see “Maintenance - Cleaning of drain pump filter”) to avoid damages caused by frost.
- Never use flammable sprays or substances in the immediate proximity of the appliance.

Installation

- Remove all packaging material and transport bolts before using the appliance. Otherwise, serious damage may result.
- This appliance is equipped with a single inlet valve and can be connected to the cold water supply only.
- The mains plug must be accessible after installation.
- Before washing clothes for the first time, the product shall be operated once throughout all the procedures without any clothes inside.
- Before using the washing machine, the product should be calibrated.
- Do not put any excessively heavy objects on the appliance, like water containers or heating devices.
- The new hose-sets supplied with the appliance are to be used and that old hose-sets should not be reused.
- Max. Inlet water pressure 1 MPa. Min. inlet water pressure 0.05 MPa.

Electrical Connection

- Make sure the supply cable is not trapped by the machine, it can get damaged.
- Connect the product to a grounded outlet protected by a fuse complying with the values in the “ Technical specifications” table. The grounding installation has to be made by a qualified electrician. Ensure that the machine is installed in accordance with the local regulations.

Safety Instructions

•Water and electrical connections must be carried out by a qualified technician in accordance with the manufacturer's instructions and local safety regulations.

Warning

- Don't use multiple plugs or extension cords.
- The appliance must not have an external switching device such as a timer or connected to a circuit that is regularly switched on and off.
- Do not pull the plug out of the mains outlet if there is flammable gas around.
- Never pull out power plug with wet hands.
- Always pull at the plug, not at the cable.
- Always unplug the appliance if it is not being used.

Water Connections

- Check the connections of the water inlet tubes, the water tap and the outlet hose for possible problems due to changes of water pressure. If the connections loosen or leak close the water tap and get it repaired. Do not use the appliance before the pipes and hoses are installed properly by qualified persons.
- Glass door may become very hot during the operation. Keep children and pets far away from the machine while it is operating.
- The water inlet and outlet hoses have to be safely installed and remain undamaged. Otherwise, water leakage can occur.
- Do not remove the drain pump filter while there is still water in the appliance. Large quantities of water can leak out, and there is a risk of scalding due to hot water.

Safety Instructions

Operation and Maintenance

- Never use any flammable, explosive or toxic solvents. Do not use gasoline and alcohol etc. as detergents. Only select detergents that are suitable for machine washing.
- Make sure that all pockets are emptied. Sharp and rigid items such as coins, brooches, nails, screws, stones etc. may cause serious damages to this machine.
- Remove all objects from pockets such as lighters and matches before using the appliance.
- Thoroughly rinse items that have been washed by hand.
- Items that have been soiled with substances such as cooking oil, acetone, alcohol, petrol, kerosene, spot removers, turpentine, wax and wax removers should be washed in hot with an extra amount of detergent before being dried in the appliance.
- Fabric softeners or similar products should be used as recommended in their instructions.
- Never try to open the door forcefully. The door will unlock shortly after the end of a cycle.
- Please do not close the door with excessive force. If it is found difficult to close the door, please check if the clothes are properly inserted and distributed.

Safety Instructions

- Always unplug the appliance and close the water tap before cleaning and maintenance and after each use.
- Never pour water over the appliance for cleaning purpose. Risk of electric shock!
- Repairs shall only be carried out by the manufacturer, its service agent or similarly qualified persons in order to avoid a hazard. The producer will not be responsible for damages caused by the intervention of not authorized persons.

Transport

- Before Transport:
 - Bolts shall be reinstalled to the machine by a specialised person
 - Accumulated water shall be drained out of the machine
- This appliance is heavy. Transport with care. Never hold any protruding part of the machine when lifting. The machine door cannot be used as a handle.

Intended Use

The product is intended only for home use and for textiles in household amounts suitable for machine washing and drying. This appliance is for indoor use only and not intended for built in use. Only use according to these instructions. The appliance is not intended for commercial use.

Any other use is considered as improper use. The producer is not responsible for any damage or injuries that may result of it.

Safety Instructions

Packaging/Old appliance



This marking indicates that this product should not be disposed with other household wastes throughout the EU. To prevent possible harm to the environment or human health from uncontrolled waste disposal, recycle it responsibly to promote the sustainable reuse of material resources. To return your used device, please use the collection systems or contact the retailer where the product was purchased. They return and can take this product for environmental safe recycling.

Installation

■ Product Description

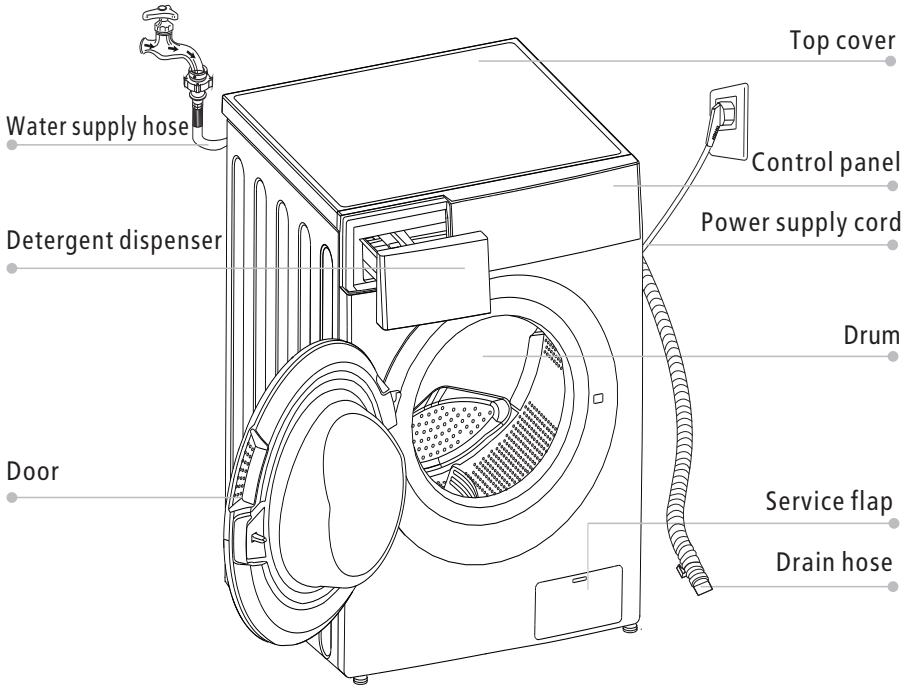

Note

- The product picture is for illustration only, please refer to real product as reference.

Accessories

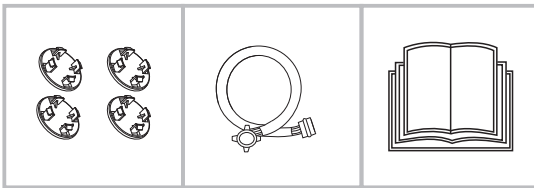

4 x Cover caps

1 x Supply hose
cold water

1 x Owner's manual

Installation

■ Installation

Installation area

⚠ Warning

- Stability is important to prevent the product from wandering! Make sure the machine is standing leveled and stable.
- Make sure that the product does not stand on the power cord.
- Make sure to maintain the minimum distances from the walls as shown in the picture

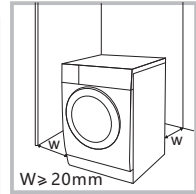

Before installing the machine, the location characterized as follows shall be selected:

1. Rigid, dry, and level surface
2. Avoid direct sunlight
3. Sufficient ventilation
4. Room temperature is above 0°C
5. Keep far away from the heat sources such as coal or gas burning appliances.

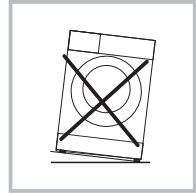

Unpacking the washing machine

⚠ Warning

- Packaging material (e.g. Films, Styrofoam) can be dangerous for children.
- There is a risk of suffocation! Keep all packaging well away from children.

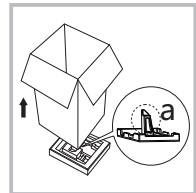

1. Remove the cardboard box and styrofoam packing.
2. Lift the washing machine and remove the base packaging. Check the small triangle foam (a) is removed with the bottom packaging together. If not, lay the unit down on the side surface and remove it manually.
3. Remove the tape securing the power supply cord and drain hose.
4. Remove the inlet hose from the drum.

Installation

Remove transport bolts

⚠ Warning

- You must remove the transport bolts from the rear before using the product.



Loosen the 4 transport bolts with a spanner.



Remove the bolts including the rubber parts and keep them for future use.

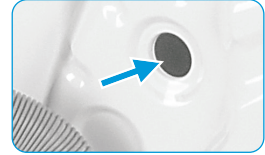

Close the holes using the cover caps.

Levelling the washing machine

⚠ Warning

- The lock nuts on all four feet must be screwed tightly against the housing.

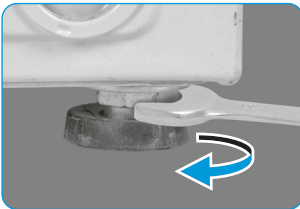

1. Loosen the lock nut.
2. Turn the foot until it reaches the floor.
3. Adjust the legs and lock the nuts with a spanner. Make sure the machine is level and steady.

Connect the water supply hose

⚠ Warning

To prevent leakage or water damage, follow the instructions in this chapter

- Do not kink, crush or modify water inlet hose.

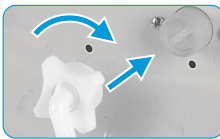

Connect the water supply hose to the water inlet valve and a water tap with cold water as indicated.



📌 Note

- Connect manually, do not use tools. Check if the connections are tight.

Installation

Drain Hose

Warning

- Do not kink or protract the drain hose.
- Position drain hose properly ,otherwise damage might result of water leakage.

There are two ways to place the end of drain hose:

1.Put it into the water trough.

2.Connect it to the branch drain pipe of the trough.

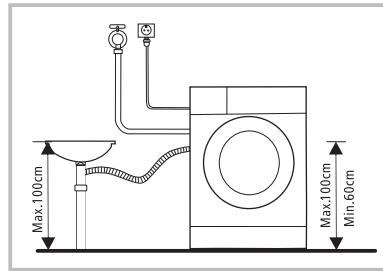
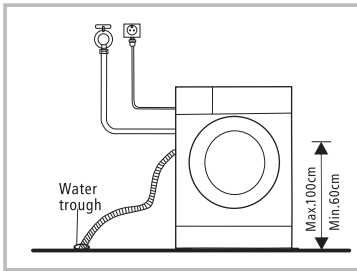

Operation

■ Quick Start

⚠ Caution

- Before washing, please make sure the washing machine is installed properly.
- Your appliance was thoroughly checked before it left the factory. To remove any residual water and to neutralize potential odors, it's recommended to clean your appliance before first use. For this reason, start the Cotton program at 90°C without laundry and detergent.

📌 Calibration

It's recommended to calibrate the washing machine, so that provide the best performance.

The appliance is able to detect the amount of laundry loaded. This function is optimizing the product performance by minimizing energy and water consumption, saving you money and time. For this reason it's recommended to calibrate the appliance for best use.

- 1- Remove all accessories from the drum and close the door;
- 2- Insert the mains plug to the socket;
- 3- Switch on the washing machine and press "Delay" and "Speed" simultaneously for 10 seconds until "t19" is displayed;
- 4- Press [▷||] to start the appliance and wait till "*****" is displayed.

Operation

1. Before Washing

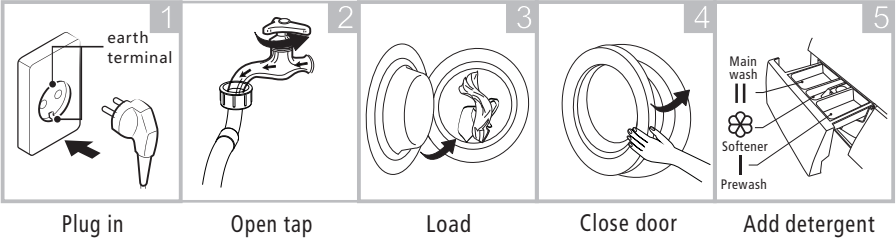

Note

- Detergent need to be added in compartment I if the pre-wash function is selected.

2. Washing

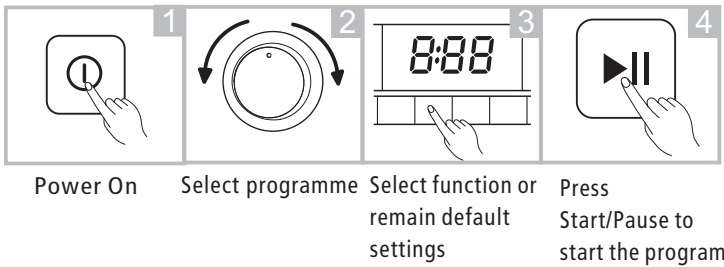

3. After Washing

Buzzer beep and “End” on display.

Operation

■ Before Each Washing

- The ambient temperature of the washing machine should be 5-40°C. If used under 0°C, the inlet valve and draining system may be damaged. If the machine is installed under freezing conditions, it should be transferred to normal ambient temperature to ensure the water supply hose and drain hose can unfreeze before use.
- Please check your laundry care labels and the detergent use instructions before wash. Use non-foaming or less-foaming detergent suitable for machine washing properly.

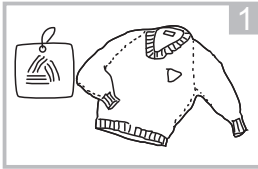

Check the care label

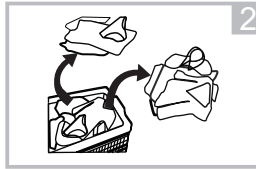

Sort laundry according to color and textile type



Take all items out of the pockets

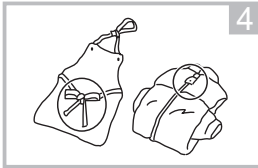

Tie together long textile strips and belts, close zips and button

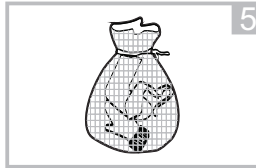

Put small items into a laundry bag

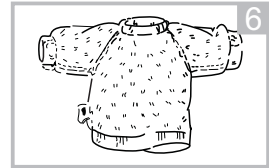

Turn easy-pilling and long-pile fabric inside out

⚠ Warning!

- Do not wash or dry articles that have been cleaned in, washed in, soaked in, or dabbed with combustible or explosive substances like wax, oil, paint, gasoline, alcohol, kerosene, and other flammable materials.
- Washing single clothes items may easily create big eccentricity and cause alarm due to unbalance. Therefore it is suggested to add one or two more laundry items to the wash so that spin can be done smoothly.

Operation

■ Detergent Dispenser

- I Pre wash
- II Main wash
- ☼ Softener
- ⊖ Release button to pull out the dispenser

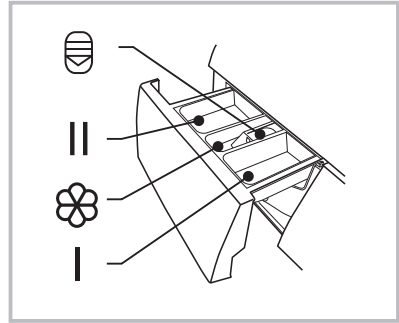

⚠ Caution

- Detergent only need to be added in "compartment I "after selecting pre-wash function.

Programme	I	II	☼	Programme	I	II	☼
Cotton	○	●	○	Sport Wear	○	●	○
Quick 15'		●	○	Synthetic	○	●	○
Rapid 45'		●	○	Mix	○	●	○
60°Wash		●	○	Delicate		●	○
ECO 40-60		●	○	Wool		●	○
Intensive		●	○	20°C		●	○
Rinse & Spin			○	Spin Only			
Sterilisation		●	○				

● Means required ○ Means optional

Detergent Recommendation

Recommended washing detergent	Wash cycles	Washing temp.	Type of laundry and textile
Heavy-duty detergent with bleaching agents and optical brighteners	Cotton,ECO 40-60,Mix, Intensive	20/30/40/60	White laundry made from boil-proof cotton or linen
Colour detergent without bleaching agent and optical brighteners	Cotton,ECO40-60,Mix, Intensive,20°C	Cold/20/30/40	Coloured laundry made from cotton or linen
Color or mild detergent without optical brighteners	20°C,Synthetic	Cold/20/30/40	Coloured laundry made from easy care fibres or synthetic materials
Mild washing detergent	Delicate	20 /30	Delicate textiles, silk, viscose
Special wool detergent	Wool	20/30	Wool

Note

- Ropy detergent or additive can be diluted in some water before pouring it into the detergent dispenser, to prevent the inlet blocking and thus cause a water overflow.
- Please choose the suitable type of detergent to get a maximum of washing performance and a minimum of water and energy consumption
- To achieve the best cleaning result a proper detergent dosing is important.
- Use a reduced detergent amount if the drum is not filled completely.
- Always adjust the amount of detergent to the water hardness, if your tap water is soft, use less detergent.
- Dose according to how dirty your laundry is, less dirty clothes require less detergent.
- Highly concentrated (compact detergent) requires particularly accurate dosing.

The following symptoms indicate detergent overdosing:

- heavy foam formation
- poor washing and rinsing result

The following symptoms indicate detergent underdosing:

- laundry turns grey
- built-up of limescale deposits on the drum, the heating element and/or the laundry

Operation

■ Control Panel

Model: CK8588

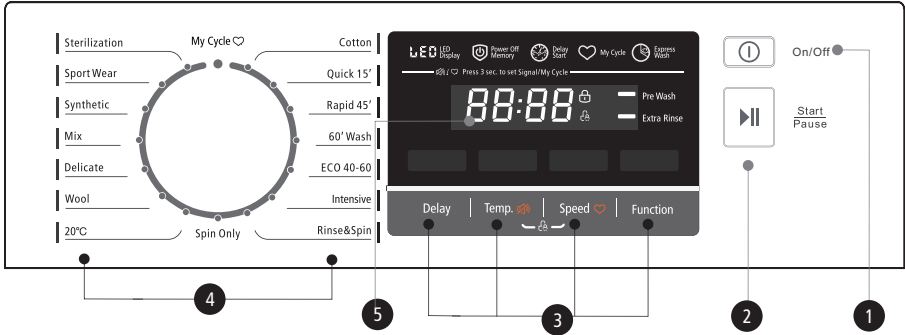

1 On/Off

Turn the appliance on and off.

2 Start/Pause

Start or pause your programme.

3 Option

This allows you to select additional functions and will light when selected.

4 Programmes

Available according to the laundry type.

5 Display

The display shows settings, estimated remaining time, options and status messages.

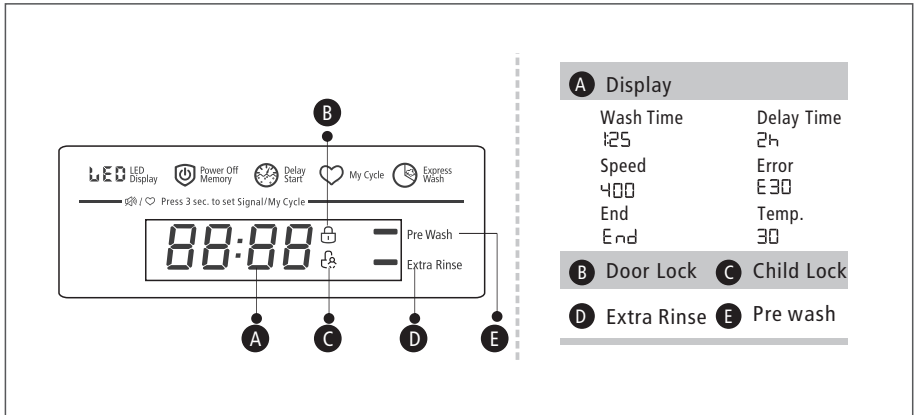

OPERATION

■ Programmes

Model: CK8588

Programme	Load (kg)					Display Time
	7.0	8.0	9.0	10.0	12.0	
	7.0	8.0	9.0	10.0	12.0	7.0/8.0/9.0/10.0/12.0
Cotton	7.0	8.0	9.0	10.0	12.0	3:39
Quick 15'	2.0	2.0	2.0	2.0	2.0	0:15
Rapid 45'	2.0	2.0	2.0	2.0	2.0	0:45
60' Wash	3.5	4.0	4.5	5.0	6.0	1:00
ECO 40-60	7.0	8.0	9.0	10.0	12.0	3:13/3:32/3:41/3:53/4:00
Intensive	7.0	8.0	9.0	10.0	12.0	3:48
Rinse&Spin	7.0	8.0	9.0	10.0	12.0	0:20
Sterilization	3.5	4.0	4.5	5.0	6.0	2:27
Sport Wear	3.5	4.0	4.5	5.0	6.0	0:45
Synthetic	3.5	4.0	4.5	5.0	6.0	3:18
Mix	7.0	8.0	9.0	10.0	12.0	1:20
Delicate	2.0	2.0	2.0	2.0	2.0	0:50
Wool	2.0	2.0	2.0	2.0	2.0	1:07
20°C	3.5	4.0	4.5	5.0	6.0	1:01
Spin Only	7.0	8.0	9.0	10.0	12.0	0:12



Note

- The parameters in this table are only for user's reference. The actual parameters maybe different with the parameters in above mentioned table.

Operation

■ Programmes

CK8588							
Cycle	Nominal capacity in kg	Temperature setting	Cycle duration in h:min	Energy consumption in kWh/cycle	Water consumption in L/cycle	Highest washing temperature °C ¹⁾	Residual moisture in % / Spin speed in rpm ²⁾
ECO 40-60 ³⁾	8.0	-	3:38	0.857	59	34	53% / 1400
	4.0	-	2:48	0.504	46	29	53% / 1400
	2.0	-	2:48	0.240	37	21	53% / 1400
20°C	4.0	20	1:01	0.15	50	20	65% / 1000
Cotton (60°C)	8.0	60	3:44	1.498	70	60	55% / 1400
Mix	8.0	40	1:20	0.75	65	40	65% / 1000
Quick 15'	2.0	Cold	0:15	0.030	40	Cold	75% / 800
Intensive	8.0	40	3:48	1.100	70	40	70% / 800

- The above data is for reference only, and the data may change due to different actual use conditions.
- The valves given for programmes other than the ECO 40-60 programme are indicative only.
- Concerning to EN 60456:2016 With (EU) 1061/2010,(EU) 1015/2010, The EU energy efficiency class is: A+++
Energy test program: Intensive 60/40 °C; Speed:The highest speed;
Other as the default.
Half load for 8.0Kg machine:4.0Kg.
- Concerning to EN 60456:2016+A11:2020 With(EU) 2019/2014, (EU) 2019/2023, (EU) 2021/340, (EU) 2021/341.
The EU energy efficiency class is: B
Energy test program: ECO 40-60. Other as the default.
Half load for 8.0Kg machine:4.0Kg.
Quarter load for 8.0Kg machine:2.0Kg.

Operation

- 1) The highest temperature reached by the laundry in the wash cycle for at least 5 minutes.
- 2) Residual moisture after the wash cycle in water content percent and the spin speed at which this was achieved.
- 3) The ECO 40-60 programme is able to clean normally soiled cotton laundry declared to be washable at 40°C or 60°C, together in the same cycle. This programme is used to assess the compliance with the regulation (EU) 2019/2014, (EU) 2019/2023, (EU) 2021/340, (EU) 2021/341.

The most efficient programmes in terms of energy consumption are generally those that perform at lower temperatures and longer duration.

Loading the household washing machine up to the capacity indicated for the respective programmes will contribute to energy and water savings.

Noise and remaining moisture content are influenced by the spinning speed: the higher the spinning speed in the spinning phase, the higher the noise and the lower the remaining moisture content.

Caution

- If there is any break in the power supply while the machine is operating, a special memory stores the selected programme. The machine will continue the programme when the power supply is re-established.

Operation

■ Programmes

Programmes are available according to the laundry type.

Programmes	
Cotton	Hard-wearing textiles, heat-resistant textiles made of cotton or linen.
Synthetic	Synthetic articles, for example: shirts, coats, blending. While washing the knitting textiles, detergent quantity shall be reduced due to its loose string construction and easily forming bubbles.
Mix	Mixed load consisting of textiles made of cotton and synthetics.
20°C	20°C default, can choose cold water.
Quick 15'	Extra short programme approx, suitable for lightly soiled washing and small amounts of laundry.
Rapid45'	This programme is suitable for washing not very dirty clothes, save more energy and washing.
60' Wash	This programme is suitable for daily wash, for daily laundry, to achieve a good washing performance about 60min.
ECO 40-60	Default 40°C to 60°C - suitable for laundry washing at set at 40-60°C.
Wool	Machine-washable wool or richwool textiles. Especially gentle wash programme to prevent shrinkage, longer programme pauses (textiles rest in wash liquor).
Spin Only	Extra spin with selectable spin speed.
Intensive	To increase the washing effects, washing time is increased.
Sterilisation	Keep the washing temperature above 60 degrees for more than 30 minutes, effectively remove harmful bacteria.
Delicate	For delicate, washable textiles, e.g. made of silk, satin, synthetic fibres or blended fabrics.
Sport Wear	This programme is suitable for washing sportswear.
Rinse & Spin	Extra rinse with spin.

Operation

■ Option

Cycle	Default Temp.(°C)	Default spin speed in rpm		Additional functions
Wash cycles		1400	1500	
Cotton	40	1400	1500	🕒, 📏, 👑
Quick 15'	Cold	800	800	🕒
Rapid 45'	20	800	800	🕒
60' Wash	30	1000	1000	🕒
ECO 40-60	--	1400	1500	🕒
Intensive	40	800	800	🕒
Rinse&Spin	--	1000	1000	🕒, 👑
Spin Only	--	1000	1000	🕒
20°C	20	1000	1000	🕒, 👑
Wool	40	600	600	🕒, 👑
Delicate	30	800	800	🕒, 👑
Mix	40	1000	1000	🕒, 📏, 👑
Synthetic	40	1200	1200	🕒, 📏, 👑
Sport Wear	20	800	800	🕒, 📏, 👑
Sterilization	70	800	800	🕒, 👑

📌 Note

- For the maximum spin speed, program time, and other details of the ECO 40-60 program, please refer to the content on the Product Features page.
- The table shows which cycle offers which options for adjustment. If an adjustment is not possible for a cycle.

Operation

Delay

Delay

Set the Delay function:

1. Select a programme; 2. Press the Delay button to choose the time (the delaying time is 0-24 H.); 3. Press [Start/Pause] to commence the delay operation



Delay



Choose the Programme Setting time Start

Cancel the Delay function:

Press the [Delay] button until the display be 0H. It should be pressed before starting the programme. If the programme already started, should switch off programme to reset a new one.



Pre Wash

Extra washing function before the main washing cycle starts to increase the washing performance.

Note: Detergent needs to be added to the compartment I.



Extra Rinse

The laundry will undergo an extra rinse after selecting this function.



My Cycle

To memory the frequently used programme.

After choosing the programme and setting the options, press [Speed] 3 sec. before start to wash. The default setting course is Cotton.

Temp.

Temp.

When needed, the washing temperature can be adjusted by pressing the temperature button in the following steps: Cold - 20°C - 30°C - 40°C - 60°C - 90°C.

Speed

Spin Speed

When needed, the spinning speed can be adjusted pressing the Speed button in the following steps:

1400: 0-400-600-800-1000-1200-1400 1500: 0-400-600-800-1000-1200-1400-1500

Maintenance

■ Cleaning and Care

⚠ Warning

- Always unplug the appliance and close the water tap before cleaning and maintenance.

Cleaning the Cabinet

Proper maintenance on the washing machine can extend its working life. The surface can be cleaned with diluted non-abrasive neutral detergents when necessary. If there is any water overflow, use a cloth to wipe it off immediately. Never use sharp items to clean the appliance.

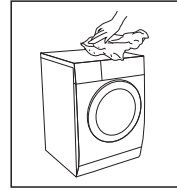

⚠ Caution

- Never use abrasive or caustic agents, formic acids or its diluted solvents or similar substances, like alcohol or chemical products.

Cleaning the Drum

Any rust stains left inside the drum by metal articles must be removed immediately using chlorine-free detergents. Never use steel wool for cleaning the drum!

📌 Note

- Keep any laundry away from the machine while cleaning the drum.

Cleaning the Door Seal and Glass

Wipe the glass and seal after each wash to remove lint and stains. If lint builds up it can cause leakages.

Remove any coins, buttons and other objects from the seal after each wash.

Clean the Door Seal and Glass every month to ensure the normal operation of the appliance.

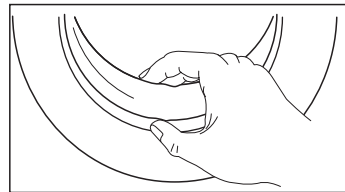

Maintenance

Cleaning the Inlet Filter

Note

- Diminishing water flow is a sign that the filter requires cleaning.

1. Close the tap and remove the water supply hose from it.
2. Clean the filter with a brush.
3. Unscrew the water supply hose from the backside of the machine. Pull out the filter with long nose pliers.
4. Use a brush to clean the filter.
5. Reinstall the filter to the water inlet and reconnect the water supply hose.
6. Clean the Inlet filter every 3 months to ensure the normal operation of the appliance.

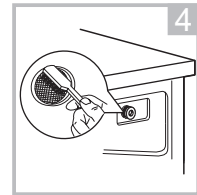
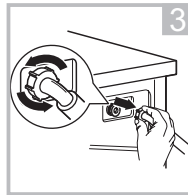
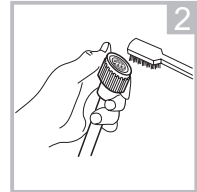
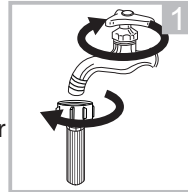

Clean The Detergent Dispenser

1. Press down the release [] on the softener cover and pull the dispenser drawer out of the recess. Clean the inside of the recess with a brush.
2. Lift the softener cover off the dispenser drawer and wash both items with water.
3. Restore the softener cover and push the drawer back into the recess.

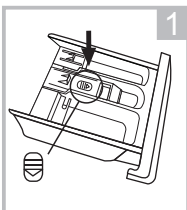

Press the release and remove the dispenser drawer

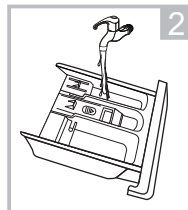

Clean the dispenser drawer and the softener cover under water

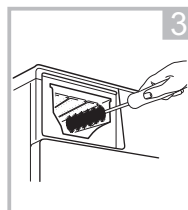

Clean the recess with a soft brush

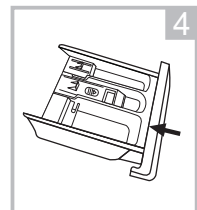

Insert the dispenser drawer

Note

- Do not use abrasive or caustic agents to clean plastic parts.
- Clean the detergent dispenser every 3 months to ensure the normal operation of the appliance.

Maintenance

Cleaning the Drain Pump Filter

⚠ Warning

- Make sure that the machine has finished the washing cycle and is empty. Switch it off and unplug it before cleaning the drain pump filter.
- Be careful of hot water. Allow the water to cool down. Risk of scalding!
- Clean the filter periodically every 3 months to ensure the normal operation of the appliance.

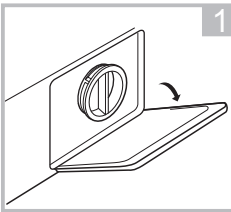

Open the lower cover cap

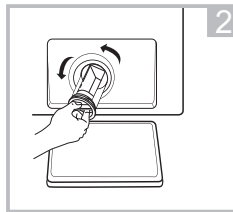

Open the filter by turning to the counter clockwise

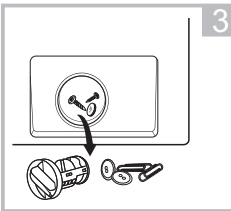

Remove extraneous matter

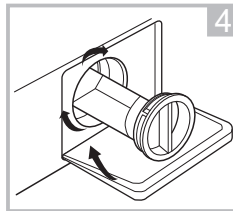

Close the lower cover cap

⚠ Caution

- When the appliance is in use and depending on the programme selected there can be hot water in the pump. Never remove the pump cover during a wash cycle, always wait until the appliance has finished the cycle, and is empty. When replacing the cover, ensure it is securely re-tightened.

Maintenance

■ Trouble Shooting

Whenever there is a problem with the appliance, check if you can solve it following the tables below. If the problem persists, please contact customer service: 01 229 480001

Description	Possible cause	Solution
Appliance does not start	Door is not closed properly. Clothes are stuck.	Close the door properly and restart. Check the laundry.
Door can't be opened	Safety protection is activated.	Disconnect the power and restart.
Water leakage	Connections are not tight enough.	Check and fasten the water inlet pipe. Check and clean the outlet hose.
Detergent residues in the detergent dispenser	Detergent is damp and/or clotted.	Clean and wipe the detergent dispenser dry.
Indicator or display does not work	PC board or harness have connection problems.	Switch off the power and check if the mains plug is connected properly.
Abnormal noise	Fixing bolts still in place. Floor is not solid or level.	Check if the fixing bolts have been removed Make sure the appliance is installed on a solid and level floor.

Error Codes

Description	Possible cause	Solution
E30	Door is not closed properly	Close the door properly and restart.
E10	Water injecting problem during wash cycle.	Check if the water pressure is high enough. Straighten the water pipe. Clean the inlet valve filter.
E21	Overtime water draining	Check the drain hose for blockage.
E12	Water overflow	Restart the appliance.
EXX	Others	Restart the appliance. If problem persists, please contact the customer service.

Maintenance

Customer service

Spare part for your appliance are available for a minimum of 10 years. In case of questions please contact Caterkwik: 01229 480001.

Warning

Risk of electric shock

- Never try repair an appliance which is defective or presumed to be defective. You may put your own and future users' lives in danger. Only authorised specialists are allowed to carry out this repair work.
- Improper repair will void the warranty and subsequent damages can't be recognized!

Transport

Important steps when moving the appliance.

- Unplug the appliance and close the water inlet tap.
 - Check, if the door and the detergent dispenser are closed properly.
- Remove the water inlet pipe and the outlet hose from the house installations.
- Let the water drain completely from the appliance (see "Maintenance Cleaning the drain pump filter")
- Important: Re-install the 4 transport bolts in the back of the appliance.
- This appliance is heavy. Transport with care. Never hold any protruding part of the machine when lifting. The machine door cannot be used as a handle.

Technical Specifications

Power Supply 220-240V~,50Hz

MAX.Current 10A

Standard Water Pressure 0.05MPa~1MPa

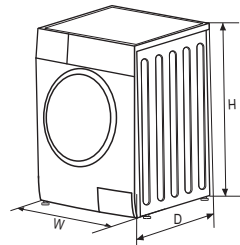

Model	Washing Capacity	Dimension (W*D*Hmm)	Net Weight	Rated Power
CK8588	8.0kg	595*565*850	68kg	2000W

Maintenance

Product fiche concerning to Regulation (EU) No 1061/2010

Trade mark	
Model identifier	CK8588
Rated capacity in kg of cotton laundry	8
Energy efficiency class on a scale from A+++ (most efficient) bis D (least efficient)	A+++
Energy consumptior 175 kWh per year, based on 220 standard washing cycles for the standard cotton programmes at 60 °C and 40 °C at full and partial load, and the consumption of the low-power modes. Actual energy consumption will depend on how the appliance is used.	
Energy consumption of the standard 60°C cotton programme at full load	0.82kwh
Energy consumption of the standard 60°C cotton programme at partial load	0.75kwh
Energy consumption of the standard 40°C cotton programme at partial load	0.73kwh
Weighted power consumption of the off-mode	0.50W
Weighted power consumption of the left-on mode	1.00W
Water consumption 11000 litres per year, based on 220 standard washing cycles for the standard cotton programmes at 60 °C and 40 °C at full and partial load. Actual water consumption will depend on how the appliance is used.	
spin-drying efficiency class B on a scale from G (least efficient) to A (most efficient)	
maximum spin speed	1400
Remaining moisture content	53%
'Intensive 60°C programme' and the 'Intensive 40°C programme' are the standard washing programmes to which the information in the label and the fiche relates, that these programmes are suitable to clean normally soiled cotton laundry and that they are the most efficient programmes in terms of combined energy and water consumption.	
Programme time of the standard 60°C cotton programme at full load	280min
Programme time of the standard 60°C cotton programme at half load	270min
Programme time of the standard 40°C cotton programme at half load	270min
duration time of left-on mode	1min
Airborne acoustical noise emissions during washing phase	57dB
Airborne acoustical noise emissions during spinning phase	79dB
'built-in' washing machine	no

Energy test program: Intensive 60/40 °C; Speed: the highest speed; Other as the default.

Maintenance

Cater-Wash

The Lakeland Catering Centre, Newland, Ulverston, Cumbria LA12 7QQ

CK8588

General product parameters:

Parameter	Value		Parameter	Value	
Rated capacity ^(b) (kg)	8.0		Dimensions in cm ^(a) ^(c)	Height	85
				Width	60
				Depth	57
Energy efficiency index ^(b) (EEI _w)	60.0		Energy efficiency class ^(b)	B ^(d)	
Washing efficiency index ^(b)	1.031		Rinsing effectiveness (g/kg) ^(b)	5.0	
Energy consumption in kWh per cycle, based on the eco 40-60 programme. Actual energy consumption will depend on how the appliance is used.	0.545		Water consumption in litre per cycle, based on the eco 40-60 programme. Actual water consumption will depend on how the appliance is used and on the hardness of the water.	48	
Maximum temperature inside the treated textile ^(b) (°C)	Rated capacity	34	Weighted remaining moisture content ^(b) (%)	53.9	
	Half	29			
	Quarter	21			
Spin speed ^(b) (rpm)	Rated capacity	1400	Spin-drying efficiency class ^(b)	B ^(d)	
	Half	1400			
	Quarter	1400			
Programme duration ^(b) (h:min)	Rated capacity	3:38	Type	free-standing	
	Half	2:48			
	Quarter	2:48			
Airborne acoustical noise emissions in the spinning phase ^(b) (dB(A) re 1 pW)	76		Airborne acoustical noise emission class ^(b) (spinning phase)	B ^(d)	
Off-mode (W) (if applicable)	0.50		Standby mode (W) (if applicable)	N/A	
Delay start (W) (if applicable)	4.00		Networked standby (W) (if applicable)	N/A	

Minimum duration of the guarantee offered by the supplier ^(a) ^(c):

This product has been designed to release silver ions during the washing cycle

NO

Additional information:

Weblink to the supplier's website, where the information in point 9 of Annex II to Commission Regulation (EU) 2019/2023 is found:

^(b) this item shall not be considered relevant for the purposes of Article 2(6) of Regulation (EU) 2017/1369.

^(c) for the eco 40-60 programme.

^(d) changes to this item shall not be considered relevant for the purposes of paragraph 4 of Article 4 of Regulation (EU) 2017/1369.

^(e) if the product database automatically generates the definitive content of this cell, the supplier shall not enter these data.

Maintenance

- 1) The actual energy consumption will depend on how the appliance is used.
- 2) The actual water consumption will depend on how the appliance is used and on the hardness of the water.
- 3) Delivery of the spare parts within 15 working days after having received the order.

Product Data Sheet concerning (EU) 2019/2014, (EU) 2019/2023, (EU) 2021/340, (EU) 2021/341.

The product data sheet for your appliance can be found online.

Go to <https://eprel.ec.europa.eu> and enter the model identifier for your appliance to download the data sheet.

The model identifier for your appliance can be found in the technical specifications section.